

Land improved on by
Dan Nithery since
warranted to Howard

Courses and Distances
Down Juniata

N 6 E 47

N 22 W 40

N 4 W 45 1/2

N 15 E 69
20 1/2

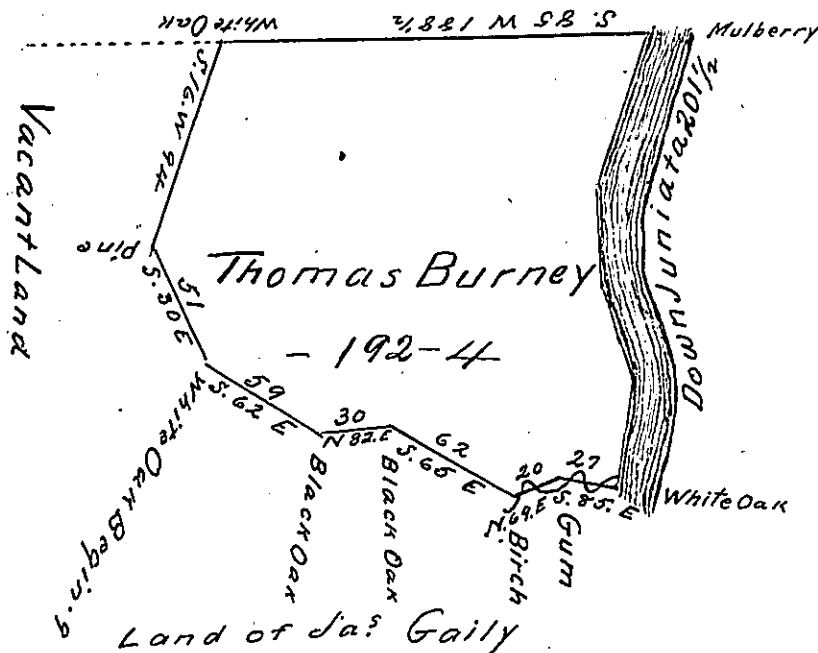

The Precise Right of a Tract of Land called—
situate on the North side of Juniata in the County
of Cumberland containing One Hundred Ninety
Two Acres 67 Perches with the usual Allowance of
Six Acres p Cent for Roads. Survey'd the 10th day
of April Anno Dom: 1766. In Pursuance of a Warrant
From the Honble Proprietaries to Thomas Burney
Bearing Date at Philad.^a the 7th day of August Anno
Dom: 1765—

Wm Maclay D. D.

To John Lukens Esq D G
of Pennsylvania

IN TESTIMONY that the above is a copy of the original remaining on file in
the Department of Internal Affairs of Pennsylvania, made
conformably to an Act of Assembly approved the 16th day of
February, 1833, I have hereunto set my Hand and caused
the Seal of said Department to be affixed at Harrisburg,
this twenty fifth day of January 1904

Lucas D. Brown
Secretary of Internal Affairs.